



SLIDING/FOLDING HARDWARE FOR TIMBER DOORS



Weatherfold 4s Hardware Details

The latest in a long line of innovation, Weatherfold 4s brings numerous new and exciting features, making it the smartest choice for exterior folding door hardware.

New locking mechanism with no loose parts

The new push button locking mechanism is

a stand-out element and is consistent across all hangers and pivots. It has no loose parts that can be misplaced during installation.

Easy adjustment

For faster installation, the locking mechanism provides easy vertical adjustment. Featuring automatic locking technology, the

system self locks as soon as the push button is released, ensuring that the panel always remains set.

The only system on the market that is fully suited in four finishes, so that your Weatherfold 4s hardware will match perfectly with the rest of your hardware.

BWS1-100H

TOP END PIVOT

- Vertical and lateral
- Very easy adjustment, with push button adjustment system ensuring pins cannot drop out during operation
- Available in mortice or non-mortice
- 100kg weight capacity



199SS

SECURITY ALIGNER BOLT

- Adjustable security aligner
- Concealed component (not visible from outside when system is closed, making forced entry difficult)



BW189H

JAMB PIVOT

- For matching hinge on door stiles
- Positive screw on jamb keep to resist doors bowing
- Recommended for door heights over 2.2m
- Easy adjustment of up to 6mm

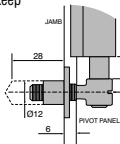

BWS1-100H

BOTTOM END PIVOT

- Metal shoe
- Universal handing



EASY ADJUSTMENT VIA ALLEN KEY WHICH IS SUPPLIED WITH KIT

882

MAGNETIC CATCH

- The magnetic catch is designed to hold adjacent panels together 16mm apart
- Available in four finishes



BWS4-100C

INTERMEDIATE HANGER SET

- Supplied with additional bearings to prevent side thrust
- Standard 100kg rollers
- Security pin
- NEW easier adjustment

EASY PRESS AND TURN FOR HEIGHT ADJUSTMENT

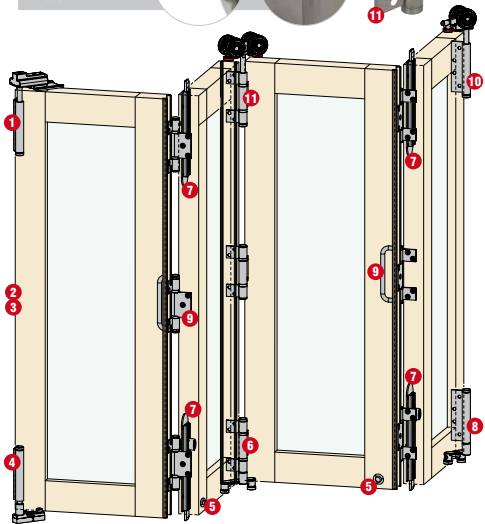
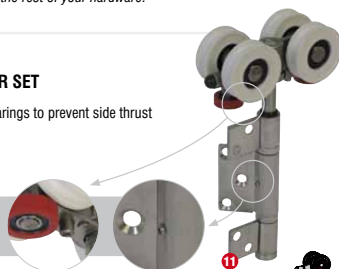

BWS4-100C

INTERMEDIATE HANGER GUIDE

- To work in conjunction with top hanger
- Security pin

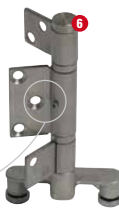

ANTI-SHAKE GRUB SCREW/SECURITY PIN



250A

TRACK

- Slim design therefore allowing smaller head sections
- Complete with "rail system" incorporated into the design to protect against side thrust
- Anodised finish as standard offering protection against the elements



BWS2 (75) (100kg available, please ask)

END HANGER SET

- NEW easier adjustment
- 100kg available comes with extra wheel for heavier doors

EASY PRESS AND TURN FOR HEIGHT ADJUSTMENT



BW7

HINGE HANDLE

- Ergonomic handle for improved feel and look
- Available in four finishes



BWS2 (75) (100kg available, please ask)

END HANGER GUIDE

- Non-handed
- Unscrew with allen key provided and turn either left or right, to make product non-handed (as shown below)

TURN FOOT OF GUIDE TO WHICH SIDE THE DOORS ARE TO BE HANDED



WEA/456R

FLUSH BOLT

- Available in 4 finishes (shown below) for an exact match to the rest of your hardware
- Available in cranked neck for inward opening
- Locking or non-locking available
- Available in 190mm, 450mm or 600mm, also available in 1000mm version (PVD & Satin Stainless only)

FINISHES



STAINLESS STEEL POLISHED CHROME PVD BRASS BLACK



Architectural Details

Weatherfold 4s

For top hung exterior folding timber doors.

TIMBER SILL

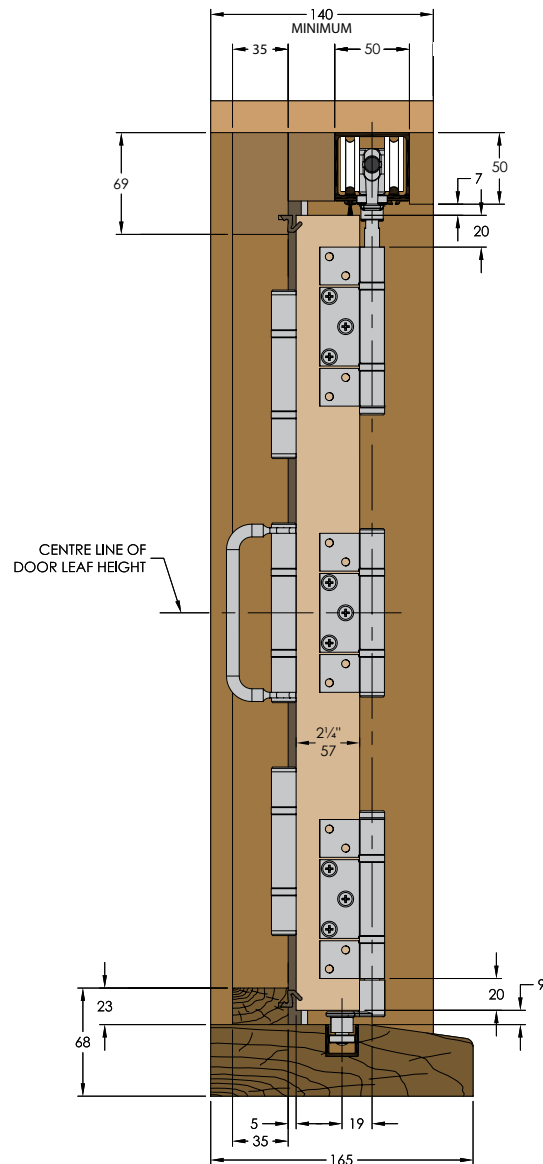

HYBRID SILL

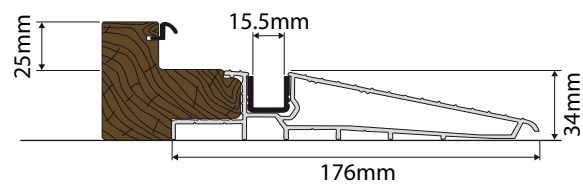

AVAILABLE IN

Anodised Aluminium (Stocked),
Brown, & Black (Special Order)
Lengths: 2m, 3m, 4m, & 5m